

A  
B  
C  
D  
E

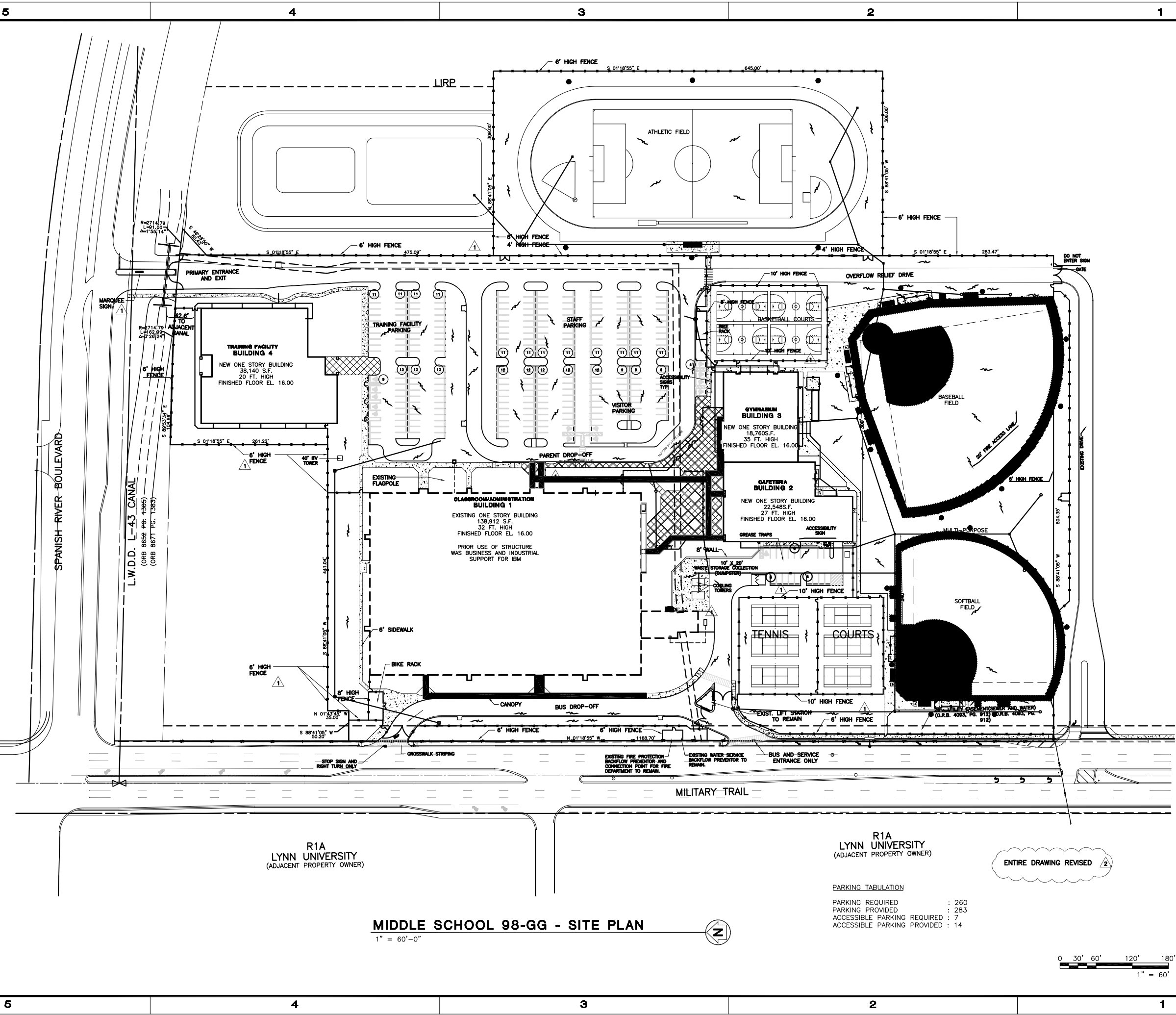

MIDDLE SCHOOL 98-GG - SITE PLAN

1" = 60'-0"



R1A  
LYNN UNIVERSITY  
(ADJACENT PROPERTY OWNER)

PARKING TABULATION

PARKING REQUIRED : 260  
PARKING PROVIDED : 283  
ACCESSIBLE PARKING REQUIRED : 7  
ACCESSIBLE PARKING PROVIDED : 14

ENTIRE DRAWING REVISED 2

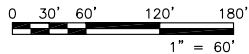

MIDDLE SCHOOL - 98GG  
BOCA RATON, FLORIDA (PROJ. NO. 2711-8193)  
SCHOOL DISTRICT OF PALM BEACH COUNTY  
SITE PLAN

BRPH ARCHITECTS ENGINEERS, INC.  
MELBOURNE / ORLANDO / WEST PALM BEACH  
3276 SUNTREE BOULEVARD  
MELBOURNE, FLORIDA 32940  
Board of Architecture License No. AL 000414  
Board of Professional Engineers License No. 118  
Copyright © 2003

ARCH/ENGR OF RECORD  
SCOTT M. KIRK  
AR91502  
DESIGNED BY  
KIRK  
DRAWN BY  
BLOMBERG  
CHECKED BY  
KIRK  
PROJECT NO./CAD CODE  
5257.01\A-1  
DATE  
05-21-03  
DRAWING NO.  
A-1  
SHEET OF

| DATE    | REVISION  | BY  | CHK |
|---------|---|-----|-----|
| 7-11-03 | SPBC COMMENTS                                     | RXI | SMK |
| 8-27-03 | ARCHITECTURAL REVISION & BLDG DEPT CLARIFICATIONS | VU  | SMK |
| 1       |   |     |     |
| 2       |   |     |     |

A  
B  
C  
D  
E